

# *Leading Solutions.*

---



**EMCOR<sup>®</sup>**

*Industrial Services*





**EMCOR Industrial Services** (EIS) greatest value is realized when major industry engages us early to deliver combined shop and field, maintenance and construction solutions. Our clients source **diverse offerings individually, or in combination**, for optimization of contracted resources.

**Leading. Solutions.** Our credo...and driver for delivering added value for our clients and shareholders.

**Our Expertise.** EIS operating companies provide tailored solutions for each project. One of our greatest strengths is communicating an idea, process design, or project that is extremely complex and challenging, yet making it simple by providing the right information to make wise decisions – who, what, when, where. EIS companies deliver **specialized work on equipment** located in **major industry processes** during **all types of events**.

**Performance Based Trust.** We are equipped to be your **FIRST CALL** to support large and complex projects when markets experience the highest demand for skilled and qualified craft. Our leadership collaborates to establish an optimum plan and strategies to achieve project goals.

**Our Predictability** can be leveraged to support other process areas and plant sites for repeatable positive project experiences that meet expectation.

**Whenever. Wherever.**  
**EMCOR Industrial Services.**





**Project Management**

**Plan on Excellence.** From phased and gated project development through project execution and completion, EMCOR Industrial Services provides professional, timely, and creative solutions for each project challenge that arises.



As each project's requirements differ, and support sought by our clients vary greatly, our role is designed to ensure client expectations and goals are executed timely and professionally. Our expertise and experience increase understanding for critical project issues, structure participant alignment and enhance execution strategies for project success. Project planning and controls increase probabilities for achieving environmental, health, safety, security, mechanical integrity, reliability, schedule, and budgetary goals.

**Benefits**

- Risk Reduction
- Cost Reduction
- Reduced Process Downtime, Improved Productivity – Craft Tool-time
- Reduced Stress for Project Leadership and Workers
- Improved Mechanical Integrity and Reliability
- Operational Efficiency
- Effective Communications
- Optimized Organization
- Improved MOC Response Time
- Integrity of Information Needed for Change Solution Decisions

**Making Connections**

In addition to connecting people and ideas, all project connections are critical with each having unique characteristics and challenges.

**Welded**

Just say NO! . . . REWORK. We understand the critical components that must merge to ensure proper fit-up and closure. Welding is one of the most critical connections we make. The expertise required to join two base metals as one has its own set of unique challenges:

- Welding dissimilar materials together
- Welding new material to existing material
- Restricted access to the work
- Environmental influences impacting the weld
- Metallurgy resistance to the bond

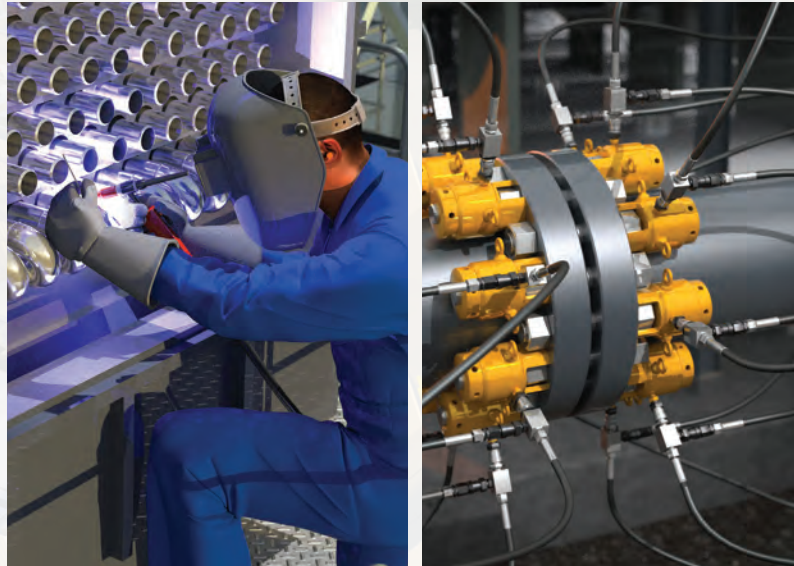

**Bolted**

Just say NO! . . . LEAKS. It is achievable every time when adhering to the tenets of "Sealing 101":

**Sealing 101**

- Right Connection Design
- Proper Procedure and Assembly

We also make easy disconnections, whenever we were the sealing provider for your last connection. We ensure a trouble-free opening by employing the latest technologies and sealing procedures to make it easy during the "next round", whenever one arises. You will consistently benefit from our expertise with decreased maintenance costs and increased reliability.

**Environmental, Health, Safety, Security**



**Mission First. People Always.** Our aim is to ensure that our thinking and actions align with our belief that all injuries and EHSS incidents are preventable. We recognize the extreme diligence, care, and investment required to ensure that our work environments are free from safety hazards that may cause injury or damage to property.

We concentrate our focus on leading indicators that identify trends to help prevent potential negative consequences. These are identified through information obtained from our field JSAs, audits, and workplace observation. We respond with specialized focus bulletins, training, and crew huddles to drive increased awareness to neutralize any heightened risk issues. **While You Work, Injuries Lurk. Be Vigilant!**



**Boilermaking**

**We Do Things Right.** Our operating companies perform boilermaking work, which encompasses a wide range of specialized services for our clients. We service equipment that operates at very high temperatures and pressures. Our expertise is sought continuously to repair stress fractures, leaks, and corrosion. We are licensed to manufacture utilizing the latest technologies to produce new equipment, make alterations, retrofit, and replace existing equipment.

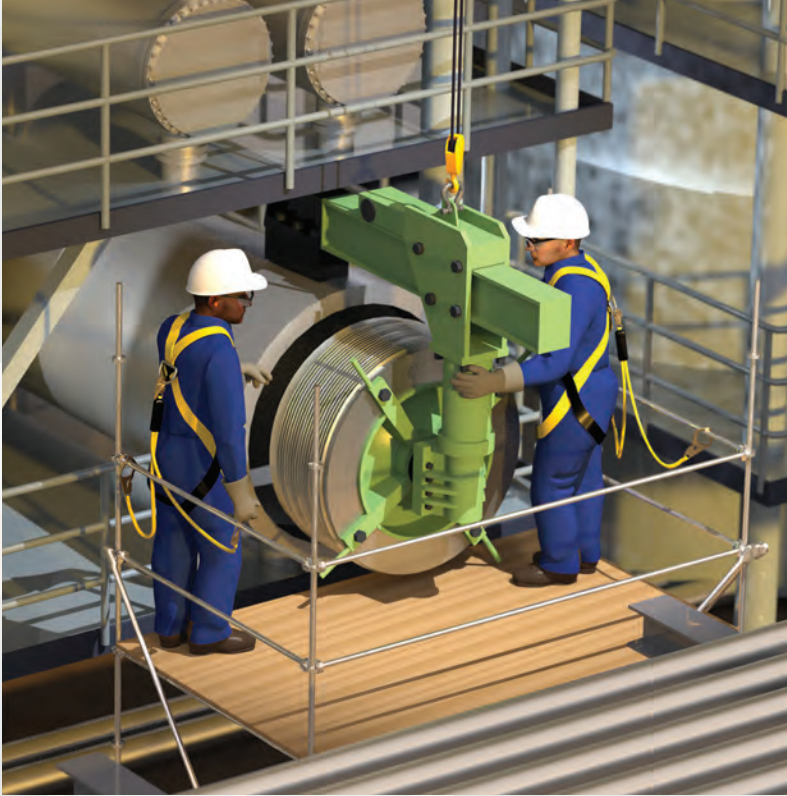

**Manufacturing/Fabrication/Assembly**



**Be the Best.** With our world-class engineering, design, machining, and welding technologies, we fabricate custom shell and tube heat exchangers ranging from 4" to 18' in diameter, with weights in excess of 660,000 pounds. Our equipment is incorporated within critical process units that must comply with stringent codes and standards, requiring tight machining tolerances and critical weld and bolted connections.

We fabricate small and large bore piping spools in both shop and field environments.

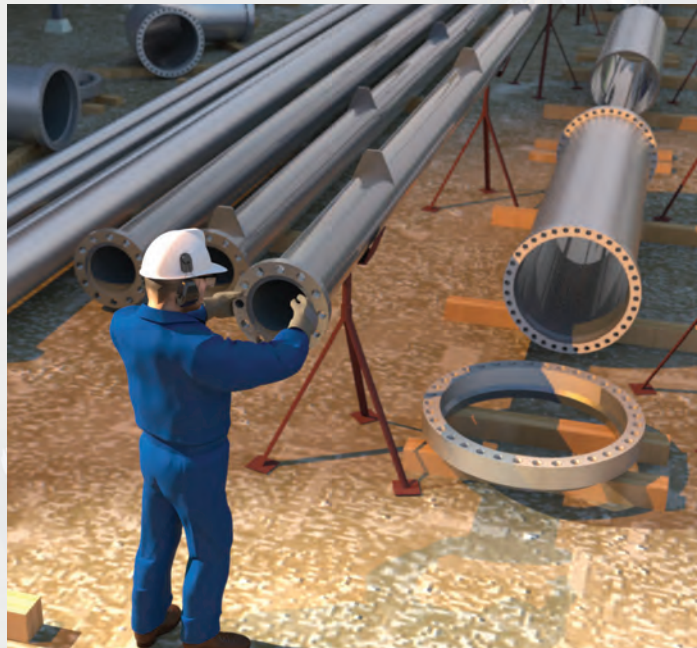

**Engineered Rigging and Lifting**

**Performance Based Trust.** We have the knowledge, experience, and innovative rigging and lifting solutions to ensure safe, timely, and reliable placement or removal of large and/or heavy equipment. We design our work activities for the least operational effects to adjacent process equipment and other competing work activities.

The catastrophic nature of a failure in this business leaves no room for a weak connection. We approach our work with respect, incorporating the greatest technical expertise and latest technology to ensure success.

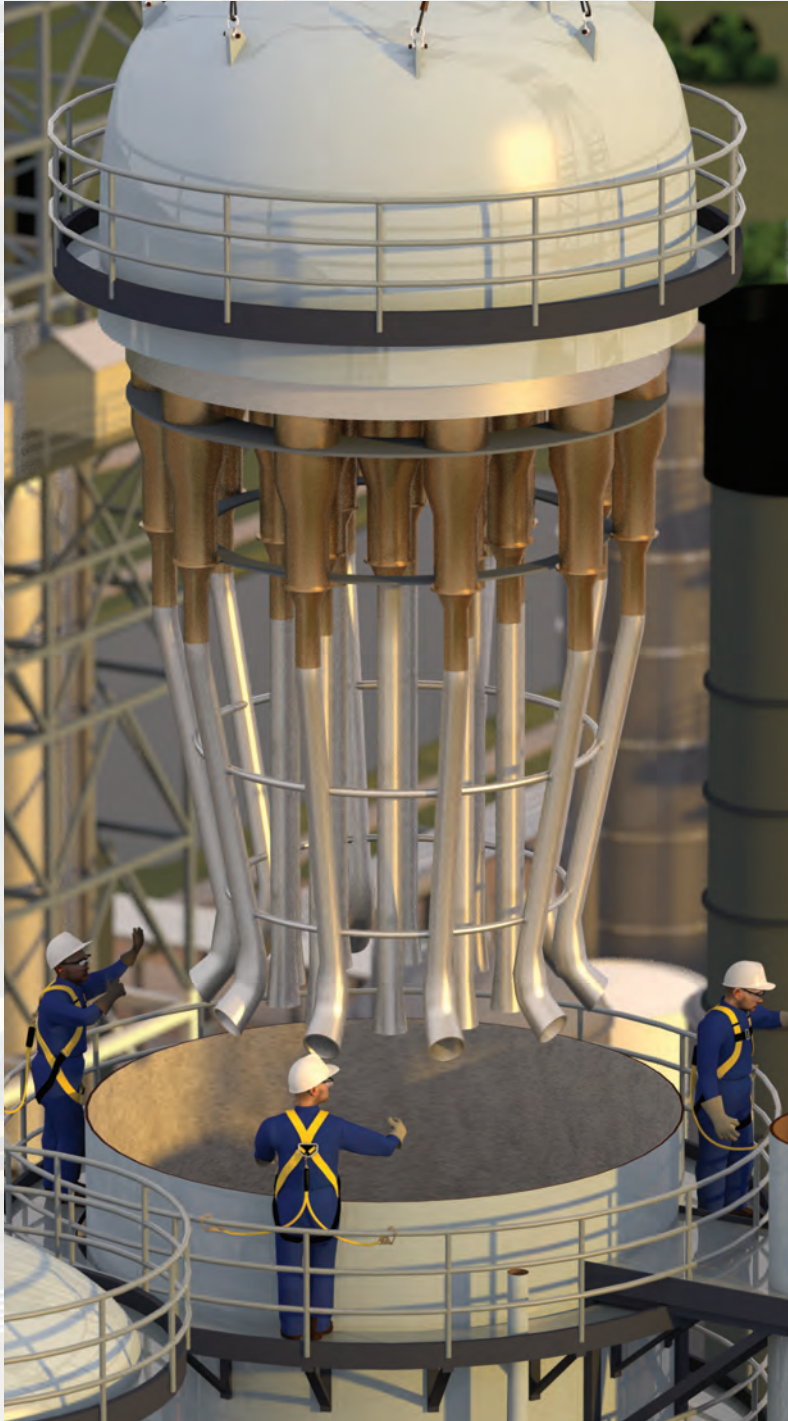

**Off-Site Cleaning**

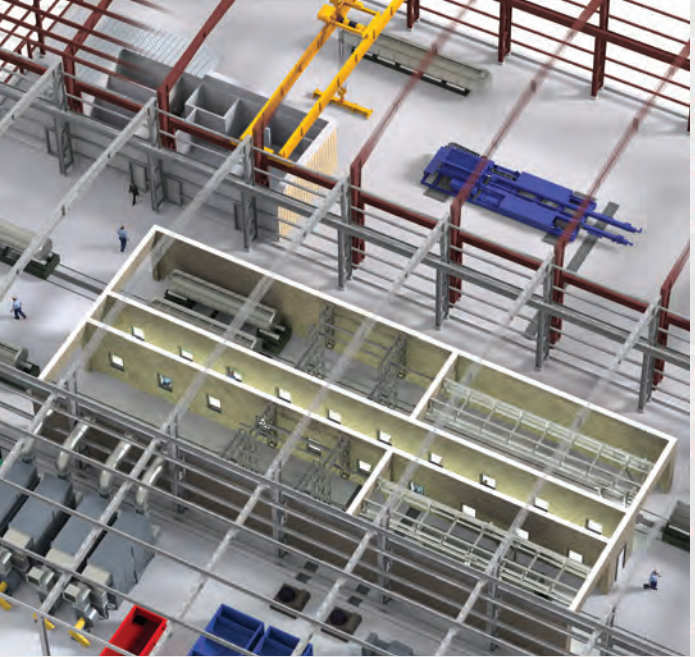

**Make It Easy.** Improve quality and reliability, reduce downtime, risk, and cost utilizing our innovative off-site cleaning solutions that can execute complete exchanger disassembly, cleaning, repair, reassembly, and testing. We provide company-owned transportation and dedicated project coordinators to facilitate staging and real-time reporting. Our operation exceeds regulatory requirements including EPA, LDEQ, and TCEQ. We are the Waste Generator of Record and provide regulated disposal.

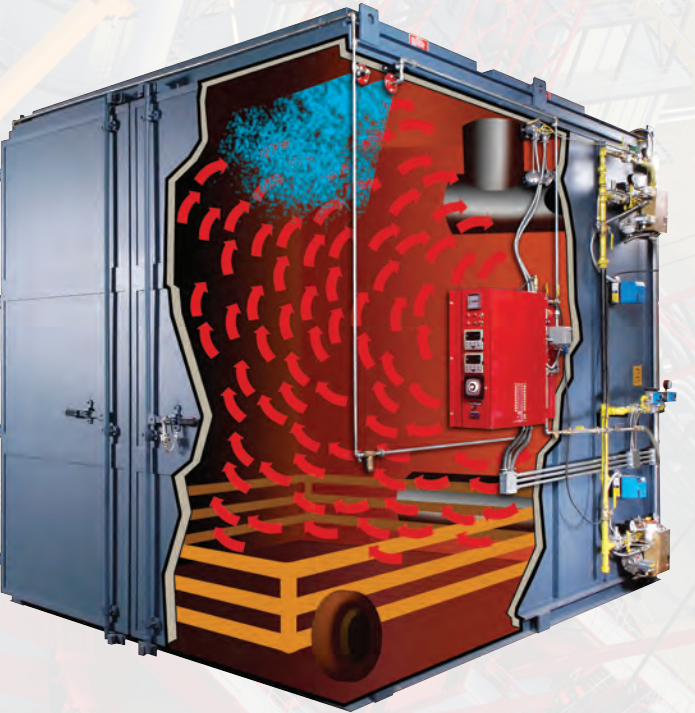

**Refractory/Fire-proofing/Acid-proofing**

**We've Got You Covered.** We specialize in protecting plant equipment from corrosion, erosion, and extreme temperatures. We provide demolition, repair, maintenance, and installation services within critical process units and equipment.





**EIS COMPANIES'  
CORPORATE OFFICES**

**EMCOR  
INDUSTRIAL SERVICES**

2450 South Shore Blvd., Suite 215  
League City, Texas 77573  
Toll Free: 800.568.5276  
T: 832.861.5975  
F: 281.783.2249  
emcoris.com

**REPCON**

7501 Up River Rd.  
Corpus Christi, Texas 78409  
Toll Free: 800.383.8681  
T: 361.289.6342  
F: 361.289.6389  
repcon.com

**ALTAIRSTRICKLAND**

1605 S. Battleground  
La Porte, Texas 77571  
Toll Free: 800.478.6206  
T: 281.478.6200  
F: 281.478.6206  
altairstrickland.com

**OHMSTEDE  
INDUSTRIAL SERVICES**

801 Georgia Ave.  
Deer Park, Texas 77536  
Toll Free: 888.803.5295  
T: 281.867.3260  
F: 281.867.3295  
ohmstede.com

**OHMSTEDE LTD.**

895 North Main St.  
Beaumont, Texas 77701  
Toll Free: 800-568-2328  
T: 409.833.6375  
F: 409.839.4948  
ohmstede.com

**REDMAN  
EQUIPMENT AND  
MANUFACTURING CO.**

19800 S. Normandie Ave.  
Torrance, California 90502-1182  
T: 310.329.1134  
F: 310.324.5656  
redmaneq.com

**TURNAROUND  
WELDING SERVICES**

13207 Airline Highway  
Gonzales, Louisiana 70737  
T: 225.686.7101  
F: 225.686.7102  
turnaroundweldingservices.com

**DIAMOND  
REFRACTORY SERVICES**

8412 Mosley Road  
Houston, Texas 77075  
T: 713.378.9200  
F: 713.378.9103  
diamondrefractory.com

**PERFORMANCE  
MECHANICAL, INC.**

701 Willow Pass Road, Suite 2  
Pittsburg, California 94565  
T: 925.432.4080  
F: 925.432.4141  
perfmech.com



**EMCOR**  
Industrial Services

emcoris.com